

STAGE 6

THE STUDIOS
★★★★at★★★★
Paramount

Floorplan

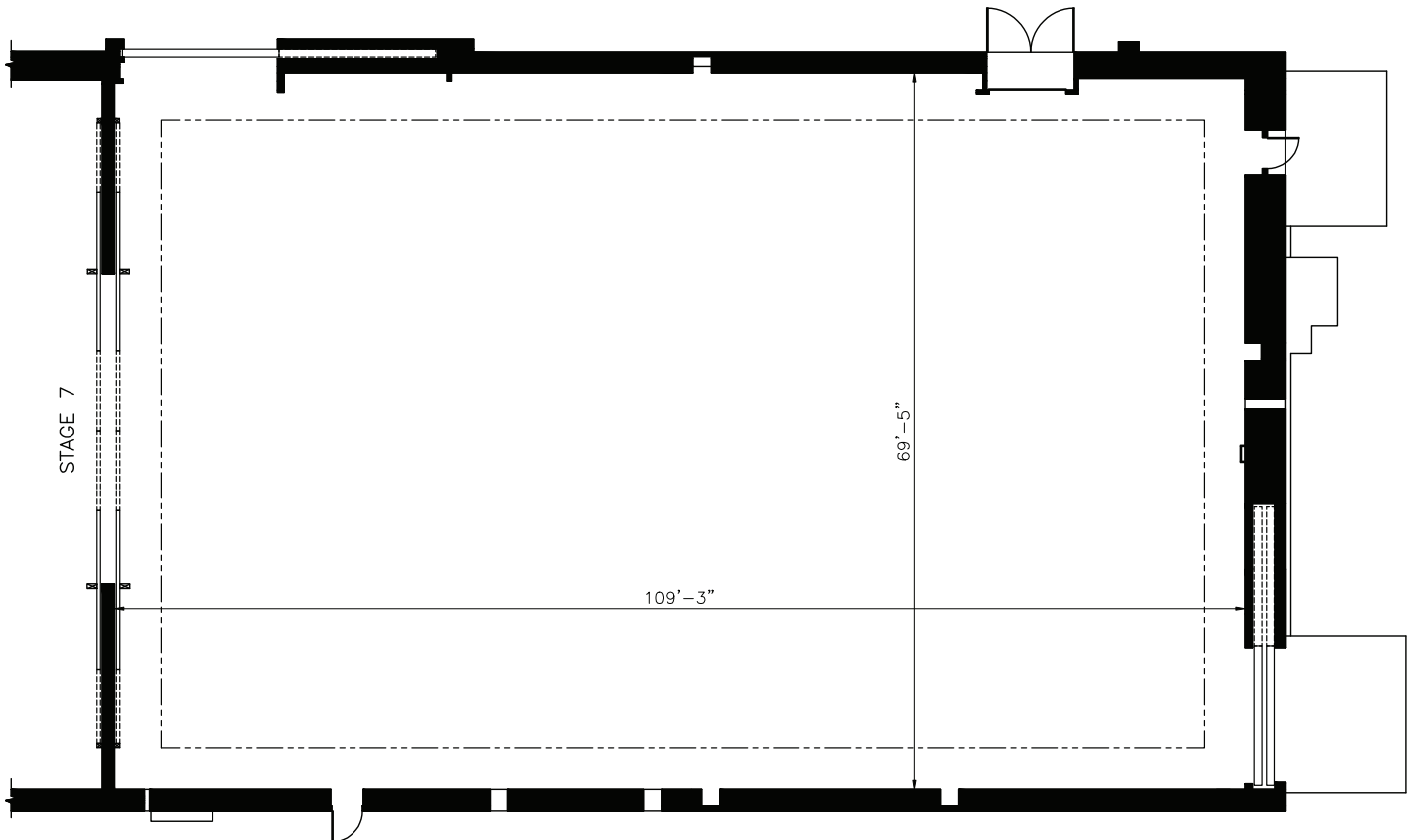

Dimensions

| | |
|----------------------------|------------------|
| Width | 109'-3" |
| Length | 69'-5" |
| Height | 30' |
| Square Feet | 7,584 |
| Door Height | 28'-6" |
| Max Weight Capacity | 10,000lbs |

Previous Productions Shot on this Stage:

Movies

Vertigo (1958)
The Molly Maguires (1968)
Houseboat (1958)
Teacher's Pet (1957)
Eddie Foy and the Seven Little Foys
Marathon Man (1976)
The Hunt for Red October (1990)

Television

The Brady Bunch
Star Trek: The Next Generation
Brooklyn Bridge
Jag
Monk
Angel

STAGE 6

THE STUDIOS
★★★★★ at ★★★★★
Paramount

Stage Location

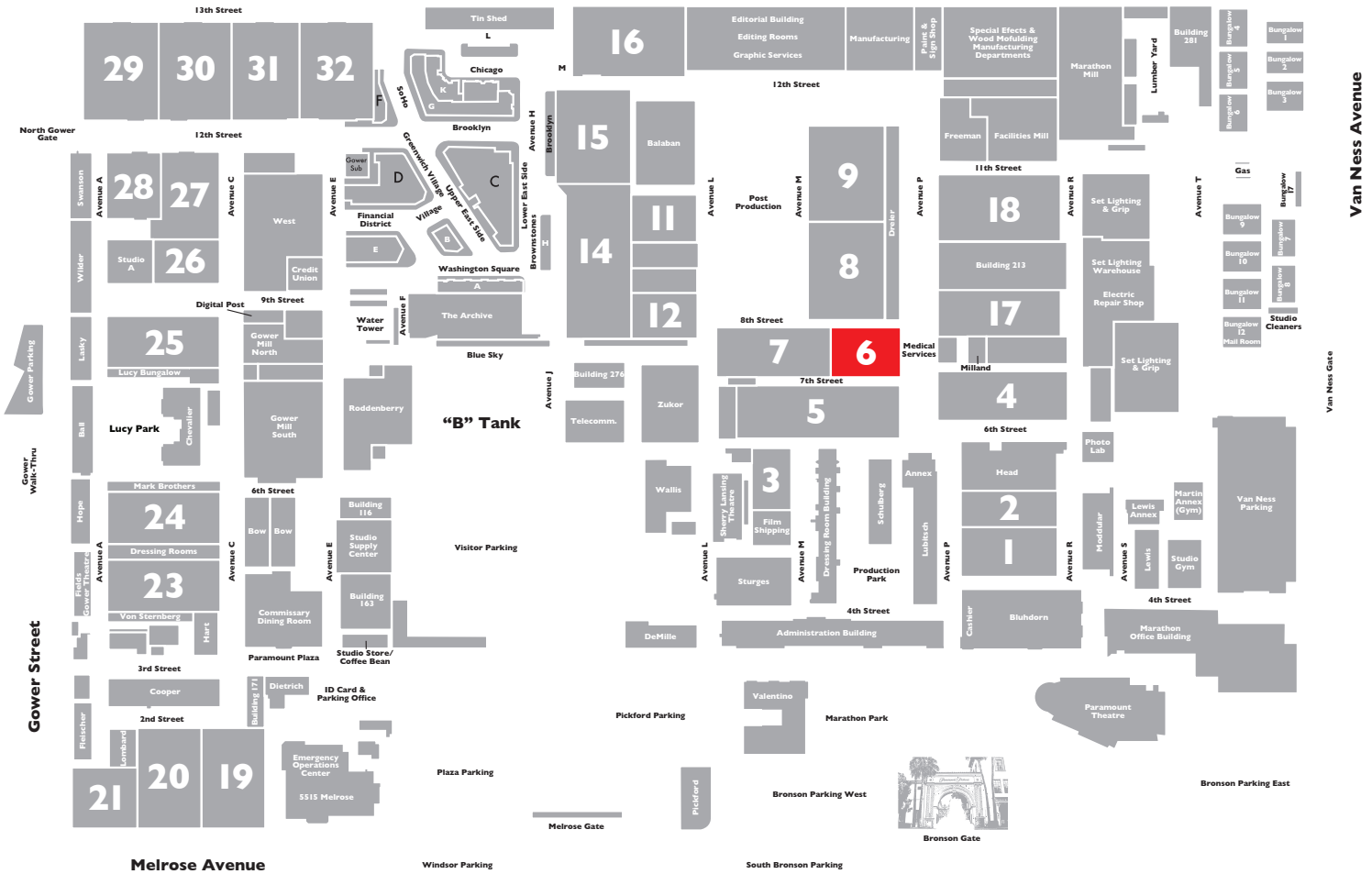

Specifications

| | |
|---------------------------------|---------------|
| Power* | 4,800A |
| HVAC | 50T |
| Red Light Controlled | No |
| Heat | No |
| Utilities (Air at 90PSI) | G/W/A |
| Wi-Fi Internet Access | |

*(IP2W fixed AC power (cam locks) available as 120/208V 3P4W)